



**FOR YOUTH DEVELOPMENT®  
FOR HEALTHY LIVING  
FOR SOCIAL RESPONSIBILITY**

Dear Health Care Providers and Parents,

In the SAGE Program the health and safety of our students is our number one priority. While our staff is trained in Medication Administration we are not health care professionals. As such, we need your help and cooperation in completing our Medication Authorization Forms in a clear manner to eliminate the possible return of forms (and double the work for parents/guardians) or potential medical error.

Below we have listed a few common items that have continually presented issue:

- Specific instructions: such as, priming instructions for an inhaler
- Dosage: If the dose can be converted between mL and mg, please have that information written down
- Medication Start and Stop Date: needs to be a specific date, per State Regulations
- PRN and Time of Administration: please do not use abbreviations we are not familiar with BID or TID
- PRN: If the medication is listed every 4 hours (Q4), please list why it is needed (i.e. coughing or wheezing)
- Side Effects of Medication: While Benadryl may make one student drowsy, it may make another excited.

We thank you for your help in making our program as safer one.

Sincerely,

**Emily Walter**  
Director of Childcare Services  
Wallingford Family YMCA  
ewalter@wallingfordymca.org

**Pam Cucinelli**  
Health Consultant  
School Age Growth & Enrichment Program  
Wallingford Family YMCA

**EPI PACKET**

**Authorization for the Administration of Medication by School, Child Care, and Youth Camp Personnel**

In Connecticut schools, licensed Child Care Centers and Group Care Homes, licensed Family Care Homes, and licensed Youth Camps administering medications to children shall comply with all requirements regarding the Administration of Medications described in the State Statutes and Regulations. Parents/guardians requesting medication administration to their child shall provide the program with appropriate written authorization(s) and the medication before any medications are administered. Medications must be in the original container and labeled with child's name, name of medication, directions for medication's administration, and date of the prescription.

**Authorized Prescriber's Order (Physician, Dentist, Optometrist, Physician Assistant, Advanced Practice Registered Nurse or Podiatrist):**

Name of Child/Student \_\_\_\_\_ Date of Birth \_\_\_/\_\_\_/\_\_\_ Today's Date \_\_\_/\_\_\_/\_\_\_

Address of Child/Student \_\_\_\_\_ Town \_\_\_\_\_

Medication Name/Generic Name of Drug Epinephrine Controlled Drug?  YES  NO

Condition for which drug is being administered: \_\_\_\_\_

Specific Instructions for Medication Administration \_\_\_\_\_

Dosage \_\_\_\_\_ Method/Route \_\_\_\_\_

Time of Administration \_\_\_\_\_ If PRN, frequency \_\_\_\_\_

Medication shall be administered: **Start Date:** \_\_\_/\_\_\_/\_\_\_ **End Date:** \_\_\_/\_\_\_/\_\_\_

Relevant Side Effects of Medication \_\_\_\_\_  None Expected

Explain any allergies, reaction to/negative interaction with food or drugs \_\_\_\_\_

Plan of Management for Side Effects \_\_\_\_\_

Prescriber's Name/Title \_\_\_\_\_ Phone Number (\_\_\_\_) \_\_\_\_\_

Prescriber's Address \_\_\_\_\_ Town \_\_\_\_\_

Prescriber's Signature \_\_\_\_\_ Date \_\_\_/\_\_\_/\_\_\_

School Nurse Signature (if applicable) \_\_\_\_\_

**Parent/Guardian Authorization: Please be sure to check the necessary boxes below**

- I request that medication be administered to my child/student as described and directed above
- I hereby request that the above ordered medication be administered by school, child care and youth camp personnel and I give permission for the exchange of information between the prescriber and the school nurse, child care nurse or camp nurse necessary to ensure the safe administration of this medication. I understand that I must supply the school with no more than a three (3) month supply of medication (school only.)
- I have administered at least one dose of the medication with the exception of emergency medications to my child/student without adverse effects. (For child care only)

Parent/Guardian Signature \_\_\_\_\_ Relationship \_\_\_\_\_ Date \_\_\_/\_\_\_/\_\_\_

Parent /Guardian's Address \_\_\_\_\_ Town \_\_\_\_\_ State \_\_\_\_\_

Home Phone # (\_\_\_\_) \_\_\_\_\_ - \_\_\_\_\_ Work Phone # (\_\_\_\_) \_\_\_\_\_ - \_\_\_\_\_ Cell Phone # (\_\_\_\_) \_\_\_\_\_ - \_\_\_\_\_

**SELF ADMINISTRATION OF MEDICATION AUTHORIZATION/APPROVAL**

Self-administration of medication may be authorized by the prescriber and parent/guardian and must be approved by the school nurse (if applicable) in accordance with board policy. In a school, inhalers for asthma and cartridge injectors for medically-diagnosed allergies, students may self-administer medication with only the written authorization of an authorized prescriber and written authorization from a student's parent or guardian or eligible student.

Prescriber's authorization for self-administration:  YES  NO \_\_\_\_\_  
Signature Date

**Parent/Guardian authorization for self-administration:**  YES  NO \_\_\_\_\_  
Signature Date

School nurse, if applicable, approval for self-administration:  YES  NO \_\_\_\_\_  
Signature Date

**Today's Date** \_\_\_\_\_ Printed Name of Individual Receiving Written Authorization and Medication \_\_\_\_\_

Title/Position \_\_\_\_\_ **Signature (in ink or electronic)** \_\_\_\_\_

**Note: This form is in compliance with Section 10-212a, Section 19a-79-9a, 19a-87b-17 and 19-13-B27a(v.)**

## Medication Administration Record (MAR)

Name of Child/Student \_\_\_\_\_ Date of Birth \_\_\_\_/\_\_\_\_/\_\_\_\_

Pharmacy Name \_\_\_\_\_ Prescription Number \_\_\_\_\_

Medication Order \_\_\_\_\_

Date	Time	Dosage	Remarks	Was This Medication Self Administered?	Signature of Person Observing or Administering Medication
				<input type="checkbox"/> Yes <input type="checkbox"/> No	
				<input type="checkbox"/> Yes <input type="checkbox"/> No	
				<input type="checkbox"/> Yes <input type="checkbox"/> No	
				<input type="checkbox"/> Yes <input type="checkbox"/> No	
				<input type="checkbox"/> Yes <input type="checkbox"/> No	
				<input type="checkbox"/> Yes <input type="checkbox"/> No	
				<input type="checkbox"/> Yes <input type="checkbox"/> No	
				<input type="checkbox"/> Yes <input type="checkbox"/> No	
				<input type="checkbox"/> Yes <input type="checkbox"/> No	
				<input type="checkbox"/> Yes <input type="checkbox"/> No	
				<input type="checkbox"/> Yes <input type="checkbox"/> No	
				<input type="checkbox"/> Yes <input type="checkbox"/> No	
				<input type="checkbox"/> Yes <input type="checkbox"/> No	
				<input type="checkbox"/> Yes <input type="checkbox"/> No	

\*Medication authorization form must be used as either a two-sided document or attached first and second page.

- |  |  |
|--|--|
| <input type="checkbox"/> Authorization form is complete      | <input type="checkbox"/> Medication is appropriately labeled |
| <input type="checkbox"/> Medication is in original container | <input type="checkbox"/> Date on label is current            |

Person Accepting Medication (print name) \_\_\_\_\_ Date \_\_\_\_/\_\_\_\_/\_\_\_\_

**PLACE  
PICTURE  
HERE**

Name: \_\_\_\_\_ D.O.B.: \_\_\_\_\_

Allergy to: \_\_\_\_\_

Weight: \_\_\_\_\_ lbs. Asthma:  **Yes (higher risk for a severe reaction)**  **No**

**NOTE: Do not depend on antihistamines or inhalers (bronchodilators) to treat a severe reaction. USE EPINEPHRINE.**

**Extremely reactive to the following allergens:** \_\_\_\_\_

THEREFORE:

- If checked, give epinephrine immediately if the allergen was **LIKELY** eaten, for **ANY** symptoms.
- If checked, give epinephrine immediately if the allergen was **DEFINITELY** eaten, even if no symptoms are apparent.

FOR ANY OF THE FOLLOWING:  
**SEVERE SYMPTOMS**



**LUNG**

Shortness of breath, wheezing, repetitive cough



**HEART**

Pale or bluish skin, faintness, weak pulse, dizziness



**THROAT**

Tight or hoarse throat, trouble breathing or swallowing



**MOUTH**

Significant swelling of the tongue or lips



**SKIN**

Many hives over body, widespread redness



**GUT**

Repetitive vomiting, severe diarrhea



**OTHER**

Feeling something bad is about to happen, anxiety, confusion

**OR A  
COMBINATION**  
of symptoms  
from different  
body areas.



1. **INJECT EPINEPHRINE IMMEDIATELY.**
2. **Call 911.** Tell emergency dispatcher the person is having anaphylaxis and may need epinephrine when emergency responders arrive.
  - Consider giving additional medications following epinephrine:
    - » Antihistamine
    - » Inhaler (bronchodilator) if wheezing
  - Lay the person flat, raise legs and keep warm. If breathing is difficult or they are vomiting, let them sit up or lie on their side.
  - If symptoms do not improve, or symptoms return, more doses of epinephrine can be given about 5 minutes or more after the last dose.
  - Alert emergency contacts.
  - Transport patient to ER, even if symptoms resolve. Patient should remain in ER for at least 4 hours because symptoms may return.

**MILD SYMPTOMS**



**NOSE**

Itchy or runny nose, sneezing



**MOUTH**

Itchy mouth



**SKIN**

A few hives, mild itch



**GUT**

Mild nausea or discomfort

**FOR MILD SYMPTOMS FROM MORE THAN ONE SYSTEM AREA, GIVE EPINEPHRINE.**

**FOR MILD SYMPTOMS FROM A SINGLE SYSTEM AREA, FOLLOW THE DIRECTIONS BELOW:**

1. Antihistamines may be given, if ordered by a healthcare provider.
2. Stay with the person; alert emergency contacts.
3. Watch closely for changes. If symptoms worsen, give epinephrine.

**MEDICATIONS/DOSES**

Epinephrine Brand or Generic: \_\_\_\_\_

Epinephrine Dose:  0.1 mg IM  0.15 mg IM  0.3 mg IM

Antihistamine Brand or Generic: \_\_\_\_\_

Antihistamine Dose: \_\_\_\_\_

Other (e.g., inhaler-bronchodilator if wheezing): \_\_\_\_\_

## HOW TO USE AUVI-Q® (EPINEPHRINE INJECTION, USP), KALEO

1. Remove Auvi-Q from the outer case.
2. Pull off red safety guard.
3. Place black end of Auvi-Q against the middle of the outer thigh.
4. Press firmly until you hear a click and hiss sound, and hold in place for 2 seconds.
5. Call 911 and get emergency medical help right away.

3

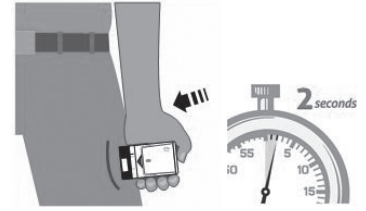

## HOW TO USE EPIPEN® AND EPIPEN JR® (EPINEPHRINE) AUTO-INJECTOR AND EPINEPHRINE INJECTION (AUTHORIZED GENERIC OF EPIPEN®), USP AUTO-INJECTOR, MYLAN AUTO-INJECTOR, MYLAN

1. Remove the EpiPen® or EpiPen Jr® Auto-Injector from the clear carrier tube.
2. Grasp the auto-injector in your fist with the orange tip (needle end) pointing downward.
3. With your other hand, remove the blue safety release by pulling straight up.
4. Swing and push the auto-injector firmly into the middle of the outer thigh until it 'clicks'.
5. Hold firmly in place for 3 seconds (count slowly 1, 2, 3).
6. Remove and massage the injection area for 10 seconds.
7. Call 911 and get emergency medical help right away.

3

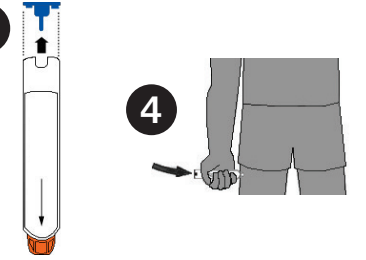

## HOW TO USE IMPAX EPINEPHRINE INJECTION (AUTHORIZED GENERIC OF ADRENACLICK®), USP AUTO-INJECTOR, IMPAX LABORATORIES

1. Remove epinephrine auto-injector from its protective carrying case.
2. Pull off both blue end caps: you will now see a red tip.
3. Grasp the auto-injector in your fist with the red tip pointing downward.
4. Put the red tip against the middle of the outer thigh at a 90-degree angle, perpendicular to the thigh.
5. Press down hard and hold firmly against the thigh for approximately 10 seconds.
6. Remove and massage the area for 10 seconds.
7. Call 911 and get emergency medical help right away.

5

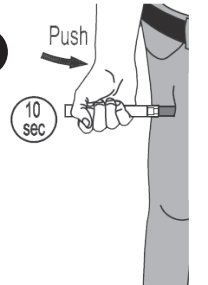

## HOW TO USE TEVA'S GENERIC EPIPEN® (EPINEPHRINE INJECTION, USP) AUTO-INJECTOR, TEVA PHARMACEUTICAL INDUSTRIES

1. Quickly twist the yellow or green cap off of the auto-injector in the direction of the "twist arrow" to remove it.
2. Grasp the auto-injector in your fist with the orange tip (needle end) pointing downward.
3. With your other hand, pull off the blue safety release.
4. Place the orange tip against the middle of the outer thigh (upper leg) at a right angle (perpendicular) to the thigh.
5. Swing and push the auto-injector firmly into the middle of the outer thigh until it 'clicks'.
6. Hold firmly in place for 3 seconds (count slowly 1, 2, 3).
7. Remove and massage the injection area for 10 seconds.
8. Call 911 and get emergency medical help right away.

5

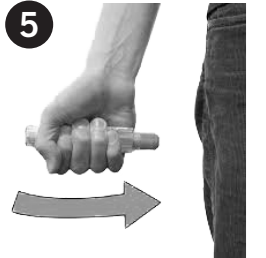

## ADMINISTRATION AND SAFETY INFORMATION FOR ALL AUTO-INJECTORS:

1. Do not put your thumb, fingers or hand over the tip of the auto-injector or inject into any body part other than mid-outer thigh. In case of accidental injection, go immediately to the nearest emergency room.
2. If administering to a young child, hold their leg firmly in place before and during injection to prevent injuries.
3. Epinephrine can be injected through clothing if needed.
4. Call 911 immediately after injection.

**OTHER DIRECTIONS/INFORMATION** (may self-carry epinephrine, may self-administer epinephrine, etc.):

Treat the person before calling emergency contacts. The first signs of a reaction can be mild, but symptoms can worsen quickly.

### EMERGENCY CONTACTS — CALL 911

RESCUE SQUAD: \_\_\_\_\_

DOCTOR: \_\_\_\_\_ PHONE: \_\_\_\_\_

PARENT/GUARDIAN: \_\_\_\_\_ PHONE: \_\_\_\_\_

### OTHER EMERGENCY CONTACTS

NAME/RELATIONSHIP: \_\_\_\_\_ PHONE: \_\_\_\_\_

NAME/RELATIONSHIP: \_\_\_\_\_ PHONE: \_\_\_\_\_

NAME/RELATIONSHIP: \_\_\_\_\_ PHONE: \_\_\_\_\_